

.032 aluminum backing

20 Ga. Galvanized or Zinalume  
standoff can be formed as zee, cee  
or hat and vary in depth as per spec  
Panels may also be mounted directly to substrate  
(ASTM tested with all configurations)

Fully adhered aluminum  
honeycomb stiffener

Field applied butyl sealant in  
female rib (per mfg. requirements)

Panels attach to stand off with  
#8 modified truss head screw

Typical 22 ga. Kynar Painted  
Zinalume Coated Steel  
(Also available in aluminum)

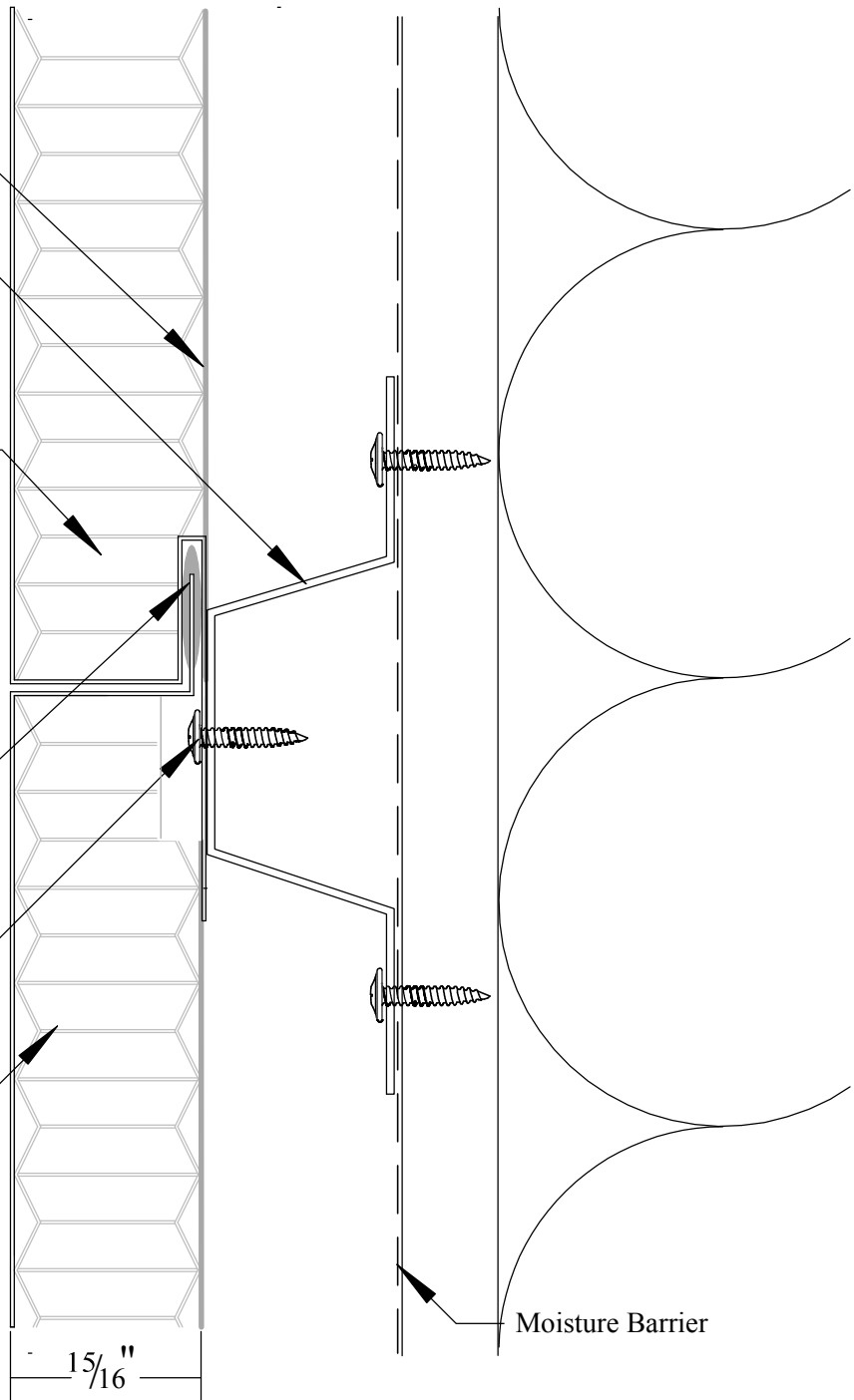

## TYPICAL HORIZONTAL JOINT

December 2009

**MF-COR-D1**  
120-01

# Metposite STD 1" Core E-84

Copyright (c) 2008 Metposite LLC, all rights reserved under U.S. and international law



**Metposite LLC**

2983 D Street Hubbard, Oregon 97932

P 503.981.5900 F 503.981.5901

www.metposite.com